

LIVING SHOWROOM SERIES VOL.4  
AUSTRALIAN INSTITUTE OF ARCHITECTS WA  
- 20 YEAR PARTNERSHIP EDITION 2018



living

**20**  
**years**

Celebrating a 20 year partnership  
with Australian Institute of Architects  
WA Chapter and Mondoluce

WELCOME TO THE LIVING SHOWROOM  
SERIES, A REAL-WORLD LIGHTING JOURNEY  
WHERE YOU CAN WITNESS AESTHETICALLY  
BRILLIANT SOLUTIONS SHINING BRIGHTLY.

*Living*  
SHOWROOM







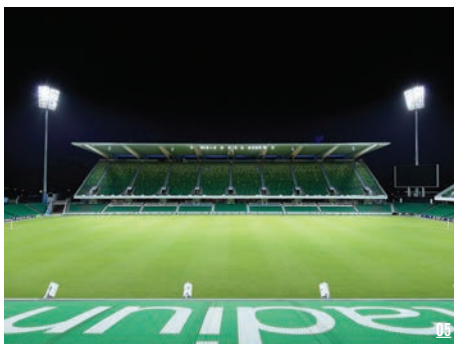

## AS YOUR TRUSTED LIGHTING PARTNER, WE'LL HELP YOU FIND THE BEST LIGHTING SOLUTION.

Welcome to Living Showroom, a sample showcase of Monduluce's commissioned lighting installations. We hope this brochure helps demonstrate the true potential of our products in practice, which can be hard to envision in a showroom alone.

*living*  
SHOWROOM

Lighting solutions are intended to add depth and dimension, light and shade, scale and drama, or safety and confidence to the spaces they illuminate. As your lighting partner, it's our job to introduce you to all the possibilities, alternatives and solutions imaginable. We have the knowledge, experience, product range and professionalism to expertly deliver even the most complex and challenging lighting design solutions.

We love lighting – it's sheer aesthetic brilliance, its beauty, its functionality and its ability to add atmosphere to any space. We hope you enjoy these installation as much as we enjoyed producing them, in collaboration with valued design professionals.

- 01 Fremantle Mausoleum
- 02 Mary Davies Library and Community Centre
- 03 Como the Treasure at The State Buildings
- 04 Office of the Premier and Cabinet Rooms
- 05 nib Stadium
- 06 West Australian Ballet Centre
- 07 Whitfords City Shopping Centre
- 08 St Ives Carine
- 09 Wembley Mini Golf
- 10 Joseph Banks Secondary College
- 11 Alotf Hotel
- 12 Aubin Grove
- 13 Perth Bus Port
- 14 Trinity College Gym
- 15 Scarborough Beach Pool





# 01.

## FEATURE PROJECT FREMANTLE MAUSOLEUM, PALMYRA

### CLIENT

Metropolitan  
Cemeteries Board

### ARCHITECT

Design Inc.

### LOCATION

Carrington Street &  
Leach Highway,  
Palmyra WA 6157



Winner of the 2006 George Temple Pool Award for the year's most outstanding overall building, the impressive **Fremantle Mausoleum** accommodates over 1000 crypts and creates a sustaining religious presence in the Fremantle Cemetery landscape. The Mausoleum was noted by the Award's jury for its bold contemporary expression and remarkable aesthetics from every viewpoint.

### LIGHTING PLAN

The design is classical and timeless, drawing reference and inspiration from the ethereal symbols and imagery associated with the Christian faith. There is a strong emphasis on the cross as the most powerful and recognisable symbol, while the dome and pyramid are a nod to ancient and traditional mausoleum design. The design forms the basis for the artwork and sculptures that complement the building.

### **2006 WA Architecture Awards, winners in the following categories:**

- George Temple Poole Award
- Award for Public Architecture
- Award for Interior Architecture

*living*  
SHOWROOM











To discover more images and the products used on this project please visit [www.mondoluce.com.au](http://www.mondoluce.com.au)

# 02

## FEATURE PROJECT ST IVES, CARINE

### CLIENT

**St Ives Retirement Living**

### ARCHITECT

**HASSELL Studio**

### ELECTRICAL ENGINEER

**Wood & Grieve Engineers**

### ELECTRICAL CONTRACTOR

**Lindquist Electrical Services**

### BUILDER

**BGC Construction**

### LOCATION

**Gemstone Boulevard,  
Carine WA 6020**

### PHOTOGRAPHY

**Ron Tan**



Surrounded by leafy streets, parks and bushland reserves, **St Ives Carine** Retirement Village is a premium resort consisting of 165 apartments and penthouses. Each residence features a luxurious level of specification with many enjoying stunning ocean and inland views. Wood & Grieve Engineers were enlisted to source lighting solutions that accommodated both the design aesthetic of the apartments and the multi-function shared spaces, whilst also providing safe and comfortable illumination for all residents.

### LIGHTING PLAN

The luxurious shared spaces of St Ives Carine are well considered and beautifully designed throughout, intended to be enjoyed as an extension of the magnificent private residences.

The entry plaza makes a stunning statement and creates a welcome impression, featuring iGuzzini Underscore to highlight the ceiling space, iGuzzini iRoll wall lights ELS SL30 suspended over the reception desk and iGuzzini Front Lights to illuminate the lounge in front of the magnificent glass feature wall. Moving beyond reception, residents and guests are met by an intimate mezzanine library and restaurant with outdoor terrace overlooking the central village gardens. The landscaping provides plenty of fitness and entertainment areas, including a pond, pool, gym and giant chessboard. With pathways illuminated by iGuzzini Twilight post tops and iGuzzini Light Up Walk, these can be enjoyed during both the day and night. St Ives Carine sets a new benchmark in luxury living for retirees with stunning architecture, sublime interiors and beautifully landscaped amenities.

*living*  
SHOWROOM













To discover more images and the products used on this project please visit [www.mondoluce.com.au](http://www.mondoluce.com.au)

# 03

## FEATURE PROJECT COMO THE TREASURY, AT THE STATE BUILDINGS

### CLIENT

**FJM Property**

### ARCHITECT

**Kerry Hill Architects**

### HERITAGE ARCHITECT

**Palassis Architects**

### BUILDER

**Built**

### LIGHTING DESIGNER

**DJ Coalition with  
Best Consultants**

### CUSTOM LIGHT FITTINGS

**Flynn Talbot**

### ELECTRICAL ENGINEER

**Best Consultants**

### ELECTRICAL CONTRACTOR

**Williams Electrical**

### LOCATION

**Cathedral Ave,  
Perth WA 6000**

### PHOTOGRAPHY

**Ron Tan**



**Como The Treasury at the State Buildings** is a popular landmark heritage/hotel project renowned for outstanding lighting design through its interior spaces and the exceptional quality of its external lighting.

### LIGHTING PLAN

External lighting distinguishes the three historic buildings in an elegant and understated manner, while cleverly considering ambient street light and the constraints of the hotel facade lighting. The entrances are warm and welcoming at street level; in a nod to its past, lamps have meticulously been reinstated on the St. Georges Terrace frontage based on historic photographs. The internal lighting creates an atmosphere of relaxed sophistication, which perfectly suits a luxury city hotel of this calibre. The lighting design has been carefully considered, using recurring geometries and themes present in the interior design. Maintaining the delicate balance between contemporary and historic, it forms an integral part of the interior design in all of the spaces, including ground floor lobbies, restaurants, corridors, private dining facilities and guest rooms.

### **2016 WA Architecture Awards, winners in the following categories:**

- George Temple Poole Award
- Margaret Pitt Morison Award for Heritage
- Colorbond® Award for Steel Architecture
- Monduluce Lighting Award
- Commendation for Interior Architecture







COMO THE TREASURY







To discover more images and the products used on this project please visit [www.mondoluce.com.au](http://www.mondoluce.com.au)



# 04

## FEATURE PROJECT NIB STADIUM

### CLIENT

**nib**

### ARCHITECT:

**Cox Howlett &  
Bailey Woodland**

### ELECTRICAL ENGINEER

**Wood & Grieve Engineers**

### ELECTRICAL CONTRACTOR

**Greenco**

### BUILDER

**BGC (Australia) Pty Ltd**

### LOCATION

**310 Pier Street  
Perth WA 6000**

### PHOTOGRAPHY

**Ron Tan**



The commanding Perth Rectangular Stadium (PRS), commonly known as **nib Stadium**, is home to two local sports codes, the Western Force and Perth Glory. Redevelopment of the ground was announced in 2011 and completed in 2013. Wood & Grieve Engineers were engaged to design the electrical and lighting services for the project.

### LIGHTING PLAN

The project included a full-roofed east stand and open south stand to bring the capacity of the stadium to 20,500, as well as new food and beverage pods, public concourse and other service areas. The east stand and concourse areas were particularly complex, creating some challenges for the lighting design. Wood & Grieve Engineers working closely with the Mondoluce team and Cox Architects to develop a solution that illuminated the east grandstand roof, complied with relevant safety standards for the general public and was unobtrusive and low-glare, ensuring it did not interfere with the game or broadcasting. The outcome was a resounding success.

### **2015 WA Architecture Awards, winners in the following categories:**

- Colorbond® Award for Steel Architecture
- Commendation for Public Architecture

*living*  
SHOWROOM



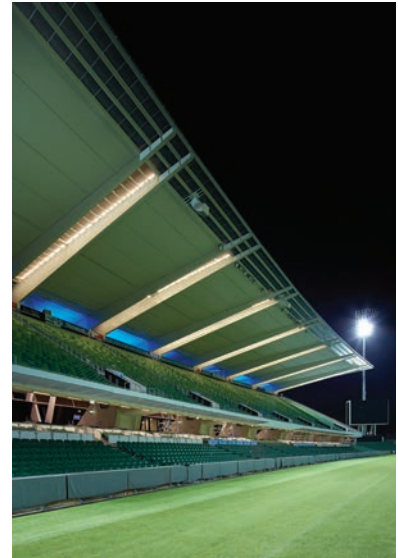





To discover more images and the products used on this project please visit [www.mondoluce.com.au](http://www.mondoluce.com.au)

## FEATURE PROJECT

### JOSEPH BANKS

### SECONDARY COLLEGE

### STAGE 2



#### CLIENT

Department of Education

#### ARCHITECT

T&Z Architects

#### ELECTRICAL ENGINEER

Wood & Grieve Engineers

#### ELECTRICAL CONTRACTOR

Stage 2: Sampson Electrical

#### BUILDER

Stage 2: Firm Construction

#### LOCATION

40 Joseph Banks Blvd,  
Banksia Grove WA 6031

#### PHOTOGRAPHY

Ron Tan

**Joseph Banks Secondary College** is recognised as one of the most progressive and well-equipped public schools in Western Australia, accommodating up to 1450 students from years seven to 12. With Stage 1 successfully completed in 2015, the second stage of the project added a number of exciting facilities to greatly enhance the students' learning experience, such as two community buildings, a Lecture Theatre complete with tiered seating, a Visual Arts and Media building with the latest state-of-the-art audio/video recording studios, art and media classrooms, a dance studio and a new student services wing. A commercial kitchen, food studio and a STEM workshop were other notable additions to the school.

#### LIGHTING PLAN

Energy saving LED fittings were used extensively throughout the second stage of the project, with slim profile Limelite Linear 100 LED luminaires used in all classrooms to create a progressive and highly effective teaching space. The Limelite Linear 100 has extremely low glare and is beautifully suited for teaching environments. The iGuzzini iSign was selected as a creative lighting solution for the dance studio in conjunction with the Limelite Ledge wall mounted uplighter. Limelite LED panels were installed to the audio/visual recording studios and associated media classrooms for uniformity and colour accuracy. The iGuzzini laser blades were used throughout the student services area to discretely blend in with the raking ceilings while still providing ample light to illuminate the space. The electrical design for both Stage 1 and 2 of the College was undertaken by Wood & Grieve Engineers in collaboration with T&Z Architects.







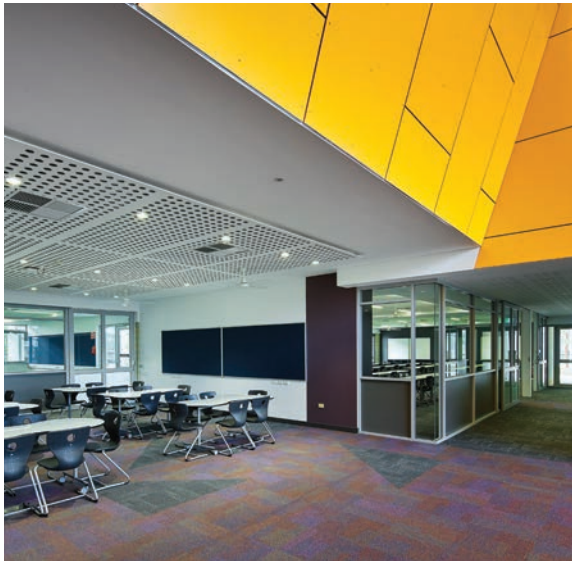



To discover more images and the products used on this project please visit [www.mondoluce.com.au](http://www.mondoluce.com.au)



# 06

## FEATURE PROJECT WEST AUSTRALIAN BALLET CENTRE

### CLIENT

**West Australian Ballet**

### ARCHITECT/DESIGNER

**Sandover Pinder Architects**

### ELECTRICAL ENGINEER

**Wood & Grieve Engineers**

### ELECTRICAL CONTRACTOR

**Everett Smith & Co Pty Ltd**

### BUILDER

**Probuild**

### LOCATION

**134 Whatley Crescent,  
Maylands WA 6051**

### PHOTOGRAPHY

**Ron Tan**



The former WA Institute for the Blind building features generous proportions, elegant pieces of original detailing and beautiful natural light, creating exquisite and appealing spaces. It is a stunning new home for the **WA Ballet Centre**, offering a magnificent aesthetic workspace and full-size studios to rehearse and perform in.

### LIGHTING PLAN

Designing for the adaptive reuse of this heritage building was as complex and intricate as a ballet performance, with similar technical and functional demands of backstage works, and performance and beauty required out front. The Monduluce team was proud to provide support on this important project, offering knowledge and advice on which lighting would best showcase the sublime features of this culturally significant building and its graceful tenants.

### **2013 WA Architecture Awards, winners in the following category:**

- Commendation for Heritage

*living*  
SHOWROOM









To discover more images and the products used on this project please visit [www.mondoluce.com.au](http://www.mondoluce.com.au)



**WE'RE NOT JUST A LIGHTING  
SUPPLIER. WE ARE YOUR  
LIGHTING PARTNER.**



A stylized, handwritten signature in black ink, appearing to read 'Gerry de Wind'.

**Gerry de Wind**  
**Managing Director**

The Mondoluce difference is this.  
We care.

When we work with you, we strive to be the most trusted lighting partner in the industry. We always bring our best to each project and treat our working relationships with the utmost respect.

We strive to be a leading project lighting specialists, and we endeavour to bring you superior and progressive lighting products for architectural, commercial, industrial and infrastructure applications.

We hope to share with you our vast knowledge about our products and the possibilities that can be achieved with lighting. We are dedicated to lighting and very passionate about the crucial role it plays in our built environment - how creative, how innovative, how sustainable, how functional and how aesthetically stunning it can be.

Based in Perth, WA, we have the highest regard for our working relationships and have done since launching in 1995. We strive to nurture and grow these relationships into trusted partnerships. We pride ourselves on providing quality products, intelligent advice, unsurpassed support and maximum value as a dependable member of your team.

What matters to us is consistently delivering quality, reliability and value through the products and services we provide to our clients. No matter the stage of the project - concept, design and specification, right through to installation, commissioning or problem solving - you're in safe hands.

That's because with Mondoluce, you're not just choosing a lighting company. You're choosing a lighting partner.

**[mondoluce.com.au](http://mondoluce.com.au)**

*living*  
SHOWROOM



*Mondoluce Headquarters, Malaga*



LIVING SHOWROOM SERIES VOL.4  
AUSTRALIAN INSTITUTE OF ARCHITECTS WA  
- 20 YEAR PARTNERSHIP EDITION 2018



**Malaga Office:**

10 Weir road  
Malaga WA 6090

**T** 08 9321 0101  
[lighting@mondoluce.com.au](mailto:lighting@mondoluce.com.au)  
[mondoluce.com.au](http://mondoluce.com.au)

[mondoluce\\_WA](#)



**20**  
**years**

Celebrating a 20 year partnership  
with Australian Institute of Architects  
WA Chapter and Mondoluce