

May 2014

## Linealuce Compact - Wall-/Ceiling-mounted - 53W 4500lm - Neutral White LED - 100-277V ac - L=1585mm - Wall Washer Spot Optic

**Product code:**

BI55

**Technical description:**

Direct light luminaire, designed to use monochrome LED lamps. Ceiling- and wall-mounted. Consists of a body and supports for installation, to be ordered separately. Extruded aluminium body, with die-cast aluminium end caps complete with silicone seals. Coated with liquid acrylic paint with a high level of weather and UV ray resistance. Lateral control gear box made of PPS (polyphenylene sulfide). The top of the optical assembly is closed by a 3 mm thick transparent glass screen, fixed with silicone. Complete with multi-LED plate in Neutral White. Fitted with optics with plastic (methacrylate) lens for Wall Washer Spot lighting. The lateral box is supplied with a double connector, male/female, with 3-pin quick coupling for pass-through wiring and a closing cap on one side. Set up for pass-through earth wiring. All external screws used are made of A2 stainless steel. The luminaire technical characteristics conform to EN 60598-1 standards and particular requirements. LED Life Time with residual flow at 80% (L80): >100,000h at Ta 25°C and >100,000h at Ta 40°C.

**Installation:**

Accessories available for installation: ±90° adjustable arms L=138mm (code 5576), arms extendable from 309 to 389mm and adjustable ±90° (code 5577), bracket for wall-mounting L=670mm (code BZ11), brackets for mounting on balustrades L297mm (code 5578), bracket for surface- or ceiling-mounting L=644mm (code 5571). For a more uniform light beam in the initial few metres, an accessory diffusing filter is available (code BZT0).

**Dimension:**

74 x 64mm L=1585mm

**Colour:**

Grey (15)

**Weight [Kg]:**

4,49

**Mounting:**

Ceiling surface|Wall surface

**Wiring:**

The product is supplied with electronic control gear, 220÷240Vac, 50/60Hz contained in the luminaire. Available for electrical connection: IP66 3-pin female connector (BZ12), IP66 3-pin male connector + closing cap (BZ13), IP66 3-pin male connector + female connector (BZ14), multi-pole cable units with 3-pin male + female connectors (BZJ0-BZJ1-BZJ2)

**Notes:**

Product complete with LED lamp.

**Product configuration: BI55+LED**

BI55: Wall-/Ceiling-mounted - 53W 4500lm - Neutral White LED - 100-277V ac - L=1585mm - Wall Washer Spot Optic

LED: LED NEUTRAL (nr.33)

**Product characteristics:**

Total lighting output [Lm]: 3344.6

Total power [W]: 59.7

Luminous efficacy [Lm/W]: 56.02

Number of optical assemblies: 1

Total luminous flux at or above an angle of 90° [Lm]: 0

Emergency luminous flux [Lm]: /

Voltage [V]: -

**Optical assembly Characteristics 1:**

Light Output Ratio (L.O.R.) [%]: 74

Lamp code: LED

ZVEI Code: LED

Nominal power [W]: 53

Nominal luminous [Lm]: 4490

Lamp maximum intensity [cd]: /

Beam angle [°]: 8°

Number of lamps for optical assembly: 1

Socket: /

Ballast losses [W]: 6.7

Colour temperature [K]: 4000

CRI: 80

Wavelength [Nm]: /

MacAdam Step: /

Complies with EN60598-1 and pertinent regulations

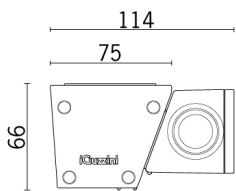

# Linealuce Compact

Design Jean Michel Wilmotte

iGuzzini

May 2014

Linealuce Compact - Wall-/Ceiling-mounted - 53W 4500lm - Neutral White LED - 100-277V ac - L=1585mm - Wall Washer Spot Optic

