

# Linealuce compact

Design Jean Michel Wilmotte

iGuzzini

May 2014

## Linealuce compact - Wall-/Ceiling-mounted - 33 Neutral White LEDs 57W 3280lm - 100-277V ac - L=1585mm - Wall Washer Optic

### Product code:

BH12

### Technical description:

Direct light luminaire, designed to use monochrome LED lamps. Ceiling- and wall-mounted. Consists of a body and supports for installation, to be ordered separately. Extruded aluminium body, with die-cast aluminium end caps complete with silicone seals. Coated with liquid acrylic paint with a high level of weather and UV ray resistance. Lateral power supply box made of PPS (polyphenylene sulfide). The top of the optical assembly is closed by a 3 mm thick transparent glass screen, fixed with silicone. Complete with multi-LED plate in Neutral White 4200K. Fitted with a PMMA diffusing filter and optic with plastic (methacrylate) lens for Wall Washer lighting. The lateral box is supplied with a double connector, male/female, with 3-pin quick coupling for pass-through wiring and a closing cap on one side. All external screws used are made of A2 stainless steel. The luminaire technical characteristics conform to EN 60598-1 standards and particular requirements. LED Life Time with residual flow at 80% (L80): >100,000h at Ta 25°C and >100,000h at Ta 40°C.

### Installation:

Accessories available for installation: ±90° adjustable arms L=138mm (code 5576), arms extendable from 309 to 389mm and adjustable ±90° (code 5577), bracket for wall-mounting L=350mm (code BZ10), brackets for mounting on balustrades L297mm (code 5578), bracket for surface- or ceiling-mounting L=350mm (code 5570)

### Dimension:

74 x 64mm L=1585mm

### Colour:

Grey (15)

### Weight [Kg]:

4,49

### Mounting:

Ceiling surface|Wall surface

### Wiring:

The product is supplied with electronic control gear, 220÷240Vac, 50/60Hz contained in the luminaire. Available for electrical connection: IP66 3-pin female connector (BZ12), IP66 3-pin male connector + closing cap (BZ13), IP66 3-pin male connector + female connector (BZ14), multi-pole cable units with 3-pin male + female connectors (BZJ0-BZJ1-BZJ2)

### Notes:

Product complete with LED lamp.

### Product configuration: BH12+LED

BH12: Wall-/Ceiling-mounted - 33 Neutral White LEDs 57W 3280lm - 100-277V ac - L=1585mm - Wall Washer Optic

LED: LED NEUTRAL (nr.33)

### Product characteristics:

Total lighting output [Lm]: 3279.05  
Total power [W]: 59.7  
Luminous efficacy [Lm/W]: 54.93  
Number of optical assemblies: 1

Total luminous flux at or above an angle of 90° [Lm]: 0  
Emergency luminous flux [Lm]: /  
Voltage [V]: -

### Optical assembly Characteristics 1:

Light Output Ratio (L.O.R.) [%]: 73  
Lamp code: LED  
ZVEI Code: LED  
Nominal power [W]: 53  
Nominal luminous [Lm]: 4490  
Lamp maximum intensity [cd]: /  
Beam angle [°]: 12°

Number of lamps for optical assembly: 1  
Socket: /  
Ballast losses [W]: 6.7  
Colour temperature [K]: 4000  
CRI: 80  
Wavelength [Nm]: /  
MacAdam Step: <3

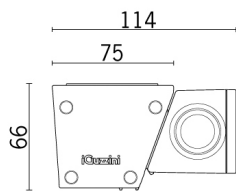

Complies with EN60598-1 and pertinent regulations



# Linealuce compact

Design Jean Michel Wilmotte

iGuzzini

May 2014

Linealuce compact - Wall-/Ceiling-mounted - 33 Neutral White LEDs 57W 3280lm - 100-277V ac - L=1585mm - Wall Washer Optic

