

# Linealuce compact

Design Jean Michel Wilmotte

iGuzzini

May 2014

## Linealuce compact - Wall-/Ceiling-mounted - 33 Neutral White LEDs 42W 2610lm - 100-277V ac - L=1585mm - Wall Washer Optic

### Product code:

BH06

### Technical description:

Direct light luminaire, designed to use monochrome LED lamps. Ceiling- and wall-mounted. Consists of a body and supports for installation, to be ordered separately. Extruded aluminium body, with die-cast aluminium end caps complete with silicone seals. Coated with liquid acrylic paint with a high level of weather and UV ray resistance. Lateral power supply box made of PPS (polyphenylene sulfide). The top of the optical assembly is closed by a 3 mm thick transparent glass screen, fixed with silicone. Complete with multi-LED plate in Neutral White 4200K. Fitted with a PMMA diffusing filter and optic with plastic (methacrylate) lens for Wall Washer lighting. The lateral box is supplied with a double connector, male/female, with 3-pin quick coupling for pass-through wiring and a closing cap on one side. All external screws used are made of A2 stainless steel. The luminaire technical characteristics conform to EN 60598-1 standards and particular requirements. LED Life Time with residual flow at 80% (L80): >100,000h at Ta 25°C and >100,000h at Ta 40°C.

### Installation:

Accessories available for installation:  $\pm 90^\circ$  adjustable arms L=138mm (code 5576), arms extendable from 309 to 389mm and adjustable  $\pm 90^\circ$  (code 5577), bracket for wall-mounting L=350mm (code BZ10), brackets for mounting on balustrades L297mm (code 5578), bracket for surface- or ceiling-mounting L=350mm (code 5570)

### Dimension:

74 x 64mm L=1585mm

### Colour:

Grey (15)

### Weight [Kg]:

4,49

### Mounting:

Ceiling surface|Wall surface

### Wiring:

The product is supplied with electronic control gear, 220÷240Vac, 50/60Hz contained in the luminaire. Available for electrical connection: IP66 3-pin female connector (BZ12), IP66 3-pin male connector + closing cap (BZ13), IP66 3-pin male connector + female connector (BZ14), multi-pole cable units with 3-pin male + female connectors (BZJ0-BZJ1-BZJ2)

### Notes:

Product complete with LED lamp.

### Product configuration: BH06+LED

BH06: Wall-/Ceiling-mounted - 33 Neutral White LEDs 42W 2610lm - 100-277V ac - L=1585mm - Wall Washer Optic

LED: LED NEUTRAL (nr.33)

### Product characteristics:

Total lighting output [Lm]: 2610.7

Total power [W]: 42.7

Luminous efficacy [Lm/W]: 61.14

Number of optical assemblies: 1

Total luminous flux at or above an angle of  $90^\circ$  [Lm]: 0

Emergency luminous flux [Lm]: /

Voltage [V]: -

### Optical assembly Characteristics 1:

Light Output Ratio (L.O.R.) [%]: 77

Lamp code: LED

ZVEI Code: LED

Nominal power [W]: 36

Nominal luminous [Lm]: 3410

Lamp maximum intensity [cd]: /

Beam angle [°]:  $12^\circ$

Number of lamps for optical assembly: 1

Socket: /

Ballast losses [W]: 6.7

Colour temperature [K]: 4000

CRI: 80

Wavelength [Nm]: /

MacAdam Step: <3

Complies with EN60598-1 and pertinent regulations

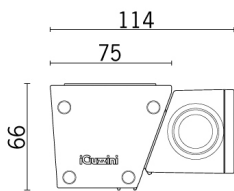

# Linealuce compact

Design Jean Michel Wilmotte

iGuzzini

May 2014

Linealuce compact - Wall-/Ceiling-mounted - 33 Neutral White LEDs 42W 2610lm - 100-277V ac - L=1585mm - Wall Washer Optic

