

May 2014

Linealuce Compact - Wall-/Ceiling-mounted - 22 Neutral White LEDs 28W 1740lm - 100-277V ac - L=1056mm - Wall Washer Optic

Product code:

BH04

Technical description:

Direct light luminaire, designed to use monochrome LED lamps. Ceiling- and wall-mounted. Consists of a body and supports for installation, to be ordered separately. Extruded aluminium body, with die-cast aluminium end caps complete with silicone seals. Coated with liquid acrylic paint with a high level of weather and UV ray resistance. Lateral power supply box made of PPS (polyphenylene sulfide). The top of the optical assembly is closed by a 3 mm thick transparent glass screen, fixed with silicone. Complete with multi-LED plate in Neutral White 4200K. Fitted with a PMMA diffusing filter and optic with plastic (methacrylate) lens for Wall Washer lighting. The lateral box is supplied with a double connector, male/female, with 3-pin quick coupling for pass-through wiring and a closing cap on one side. All external screws used are made of A2 stainless steel. The luminaire technical characteristics conform to EN 60598-1 standards and particular requirements. LED Life Time with residual flow at 80% (L80): >100,000h at Ta 25°C and >100,000h at Ta 40°C.

Installation:

Accessories available for installation: ±90° adjustable arms L=138mm (code 5576), arms extendable from 309 to 389mm and adjustable ±90° (code 5577), bracket for wall-mounting L=350mm (code BZ10), brackets for mounting on balustrades L297mm (code 5578), bracket for surface- or ceiling-mounting L=350mm (code 5570)

Dimension:

74 x 64mm L=1056mm

Colour:

Grey (15)

Weight [Kg]:

3,2

Mounting:

Ceiling surface|Wall surface

Wiring:

The product is supplied with electronic control gear, 220÷240Vac, 50/60Hz contained in the luminaire. Available for electrical connection: IP66 3-pin female connector (BZ12), IP66 3-pin male connector + closing cap (BZ13), IP66 3-pin male connector + female connector (BZ14), multi-pole cable units with 3-pin male + female connectors (BZJ0-BZJ1-BZJ2)

Notes:

Product complete with LED lamp.

Product configuration: BH04+LED

BH04: Wall-/Ceiling-mounted - 22 Neutral White LEDs 28W 1740lm - 100-277V ac - L=1056mm - Wall Washer Optic
LED: LED NEUTRAL (nr.22)

Product characteristics:

Total lighting output [Lm]: 1737.91	Total luminous flux at or above an angle of 90° [Lm]: 0
Total power [W]: 28.5	Emergency luminous flux [Lm]: /
Luminous efficacy [Lm/W]: 60.98	Voltage [V]: -
Number of optical assemblies: 1	

Optical assembly Characteristics 1:

Light Output Ratio (L.O.R.) [%]: 77	Number of lamps for optical assembly: 1
Lamp code: LED	Socket: /
ZVEI Code: LED	Ballast losses [W]: 4.5
Nominal power [W]: 24	Colour temperature [K]: 4000
Nominal luminous [Lm]: 2270	CRI: 80
Lamp maximum intensity [cd]: /	Wavelength [Nm]: /
Beam angle [°]: 12°	MacAdam Step: <3

Complies with EN60598-1 and pertinent regulations

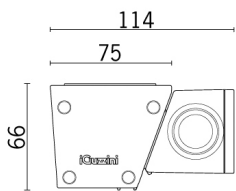

Linealuce Compact

Design Jean Michel Wilmotte

iGuzzini

May 2014

Linealuce Compact - Wall-/Ceiling-mounted - 22 Neutral White LEDs 28W 1740lm - 100-277V ac - L=1056mm - Wall Washer Optic

