

May 2014

Linealuce Compact - Wall-/Ceiling-mounted - 18 Warm White LEDs 23.4W 1050lm - 100-277V ac - L=1585mm - Wall Washer Optic

Product code:

BH01

Technical description:

Direct light luminaire, designed to use monochrome LED lamps. Ceiling- and wall-mounted. Consists of a body and supports for installation, to be ordered separately. Extruded aluminium body, with die-cast aluminium end caps complete with silicone seals. Coated with liquid acrylic paint with a high level of weather and UV ray resistance. Lateral power supply box made of PPS (polyphenylene sulfide). The top of the optical assembly is closed by a 3 mm thick transparent glass screen, fixed with silicone. Complete with multi-LED plate in Warm White 3100K. Fitted with a PMMA diffusing filter and optic with plastic (methacrylate) lens for Wall Washer lighting. The lateral box is supplied with a double connector, male/female, with 3-pin quick coupling for pass-through wiring and a closing cap on one side. All external screws used are made of A2 stainless steel. The luminaire technical characteristics conform to EN 60598-1 standards and particular requirements. LED Life Time with residual flow at 80% (L80): >100,000h at Ta 25°C and >100,000h at Ta 40°C.

Installation:

Accessories available for installation: ±90° adjustable arms L=138mm (code 5576), arms extendable from 309 to 389mm and adjustable ±90° (code 5577), bracket for wall-mounting L=350mm (code BZ10), brackets for mounting on balustrades L297mm (code 5578), bracket for surface- or ceiling-mounting L=350mm (code 5570)

Dimension:

74 x 64mm L=1585mm

Colour:

Grey (15)

Weight [Kg]:

4,49

Mounting:

Ceiling surface|Wall surface

Wiring:

The product is supplied with electronic control gear, 220÷240Vac, 50/60Hz contained in the luminaire. Available for electrical connection: IP66 3-pin female connector (BZ12), IP66 3-pin male connector + closing cap (BZ13), IP66 3-pin male connector + female connector (BZ14), multi-pole cable units with 3-pin male + female connectors (BZJ0-BZJ1-BZJ2)

Notes:

Product complete with LED lamp.

Product configuration: BH01+LED

BH01: Wall-/Ceiling-mounted - 18 Warm White LEDs 23.4W 1050lm - 100-277V ac - L=1585mm - Wall Washer Optic

LED: LED WARM (nr.18)

Product characteristics:

Total lighting output [Lm]: 1118.99
 Total power [W]: 23.8
 Luminous efficacy [Lm/W]: 47.02
 Number of optical assemblies: 1

Total luminous flux at or above an angle of 90° [Lm]: 0
 Emergency luminous flux [Lm]: /
 Voltage [V]: -

Optical assembly Characteristics 1:

Light Output Ratio (L.O.R.) [%]: 64
 Lamp code: LED
 ZVEI Code: LED
 Nominal power [W]: 20
 Nominal luminous [Lm]: 1740
 Lamp maximum intensity [cd]: /
 Beam angle [°]: 14° / 18°

Number of lamps for optical assembly: 1
 Socket: /
 Ballast losses [W]: 3.8
 Colour temperature [K]: 3000
 CRI: 85
 Wavelength [Nm]: /
 MacAdam Step: <3

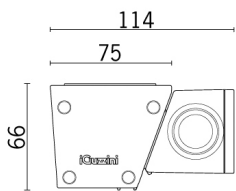

Complies with EN60598-1 and pertinent regulations



Linealuce Compact

Design Jean Michel Wilmotte

iGuzzini

May 2014

Linealuce Compact - Wall-/Ceiling-mounted - 18 Warm White LEDs 23.4W 1050lm - 100-277V ac - L=1585mm - Wall Washer Optic

