

**Odessa 1**  
Floodlights LED

**OD-50001**  
IP66 / CLASS I / F / CE / IK08



Project :	Location :	Type :	Quantity :
Note :			



**Application**

Extremely robust and compact LED floodlights with a modern aesthetic design. A small and medium range of high performance LED surface mounted provides with robust, excellent design and perfect fit for any demand applications such as corridors, public spaces, metro stations, residential areas, showrooms etc.

**Description**

The luminaire rated as CLASS I with integral driver, available in Narrow, Medium, Wide and Very Wide light distribution. Colour temperature 3000K and 4000K, LED CRI >80 and life time 50,000 Hours. Luminaire optional with visor or louvre, linear spread lens or colour filters.

Aluminium die-cast with color powder coating, LED optical reflector, cable gland entries on luminaire and gear box, stainless steel screws. Durable silicone rubber gasket and clear toughened glass.

Arm mounting installation.

www.ligman.com

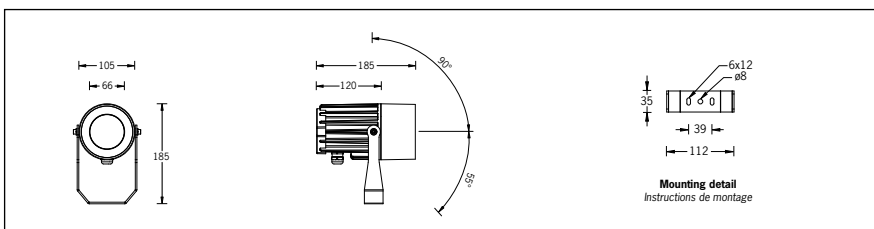

**Product Code**

Model No.	Lamp	System Power W	Lumen lm	CCT Colour	EEC	Beam Angle	Weight kg
OD-50001 - M - W30	1 LED	20.7	1653	3000K	A++	23°	1.7
OD-50001 - W - W30	1 LED	20.7	1668	3000K	A++	32°	1.7
OD-50001 - VW - W30	1 LED	20.7	1663	3000K	A++	43°	1.7
OD-50001 - M - W40	1 LED	20.7	1673	4000K	A++	23°	1.7
OD-50001 - W - W40	1 LED	20.7	1688	4000K	A++	32°	1.7
OD-50001 - VW - W40	1 LED	20.7	1683	4000K	A++	43°	1.7

**Accessory**

- A80331
- A80121
- A80214
- A50441

**Colour Code**



RESET

# Odessa 1

Floodlights LED

## OD-50001

IP66 / CLASS I / F / CE / IK08



### Photometric

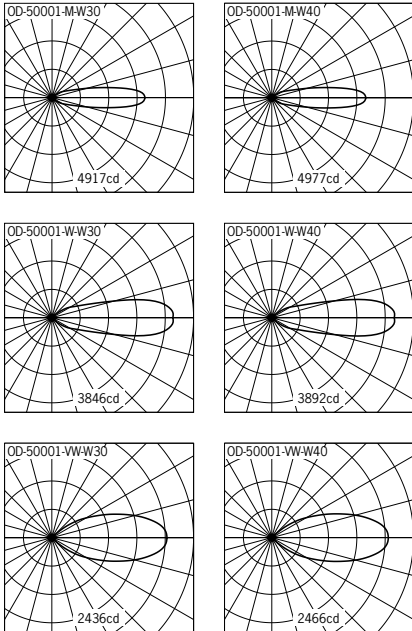

• Installation manual available online at [www.ligman.com](http://www.ligman.com).  
• Luminous flux and system power are rated from absolute photometry according to LM-79-08 standard for LED luminaire.  
• Photometric diagram for standard non-accessory, please consult the factory in case accessory option.